

# venetian blinds

## fitting instructions

### HOW TO FIT MY BLIND

You will need to decide which method of fixing you require, either TOP FIX or FACE FIX.

Top Fixing brackets are used for fixing into the ceiling or lintel and Face Fixing brackets are used to fix into the window frame (UPVC or Wood) you would always use face fix brackets when fitting outside the recess.

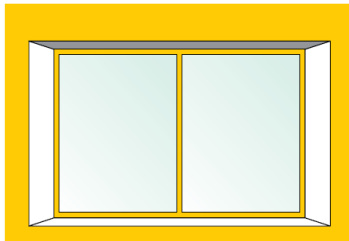

■ top fix ■ face fix

#### top fixing

Take a measurement of how far your window handles protrude from your window frame (mm) then add 20mm to that measurement, this is the distance from the window frame you will need to drill to avoid the slats catching your window handles. However before selecting a fixing point, ensure that the brackets will not be over any part of the mechanism inside the headrail, the brackets should be positioned to one side of any internal fitting.

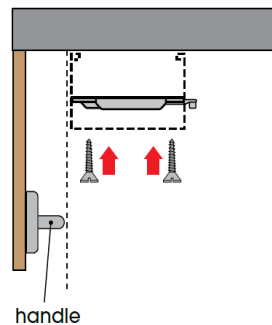

#### face fixing

When fixing into a recess and you have protruding handles on your window then you will have Top Fix as there is no space allowed in this bracket for handles. For exact blinds fix the brackets in the exact place above the recess that you took your original measurement from. Again before selecting a fixing point, ensure that the brackets will not be over any part of the mechanism inside the headrail, the brackets should be positioned to one side of any internal fitting.

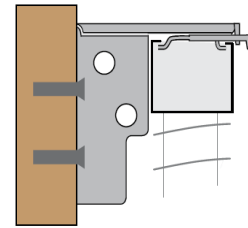

### fitting the track

The track must be set with the controls at the side ordered. After fixing the brackets pull the swing arm towards the centre until it is resting against the front lip of each bracket. Locate the headtrack between the front and back lips of the bracket and push upwards then push the swing arm back towards the headrail so that they fit flush with the front of the headrail, repeat on other brackets.

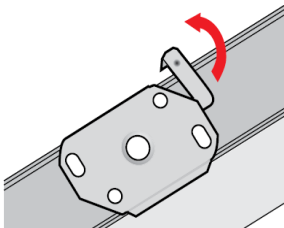

Hook the wand into the control wand filter and hang down vertically. To lower the blind, pull the cord across the face of the blind to release the cordlock and let the cord slide through your fingers until the blind reaches the desired height. Twist the wand control to adjust the angle of the slats. Slats should be in the open position when raising or lowering the blind.

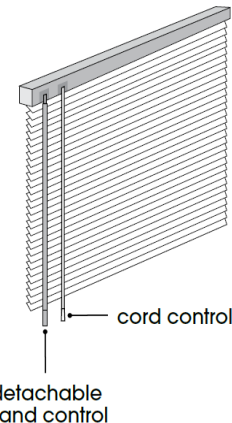

**WARNING:** Please ensure the wand is not overtightened.

**WARNING:** In the interest of safety, please keep all pull cords and chains out of the reach of children. Move cots, beds and other furniture away from blinds and install safety devices such as cleats and cord ties to limit access to cords.

### fittings

bracket (face fixing)

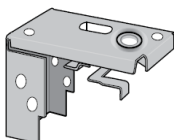

bracket (top fixing)

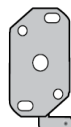

screws



rawlplugs



detachable wand control



**FIXINGS NOT INCLUDED:** USE CORRECT SCREWS & RAWL PLUGS FOR WALL TYPE!



**make it safe**